

Arteor™ ethernet switches, Wi-Fi access points

■ Installation principle

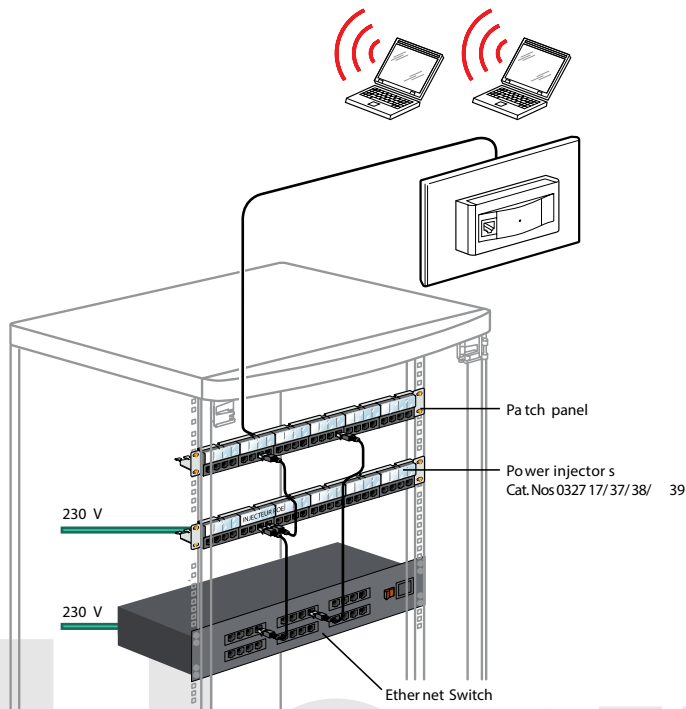

■ Arteor Wi-Fi access points

A 802.11 a and b/g solution

Radio communication standard	802.11 b/g	802.11 a
Power over Ethernet standard	802.3 af	
Frequency band	between 2.40 and 2.48 GHz	5 GHz
Number of available channels	13	8
Max. data rate	54 Mbps	54 Mbps

■ Advantages of a Legrand Wi-Fi access point

- Possibility of simultaneous operation on 2 frequencies, a and b/g
Provides a max. data rate of up to 2 x 54 Mbps in simultaneous mode
- Very high security level: encryption (WPA2 - 802.11i) and authentication (802.1x)
- Possibility of roaming (moving from one access point to another without breaking the link)
- Quality of service (priority automatically given to voice, then video and finally data) in accordance with standard 802.11e
- Easy to configure and make secure with the quick configuration node

NEW: Guest access to offer a free access for the guest and keep independent and secure the main Wi-Fi network

■ Installation

In all supports that can take an Arteor mechanism (ducting, columns, flush-mounting boxes, floor boxes, etc)
Do not place access points behind an obstacle that would limit the radiation of the antenna
Access points are connected in the same way as RJ 45 sockets

■ Sizing

- Provide 1 access point for 1 localised requirement
- Provide 1 access point per 100 m² for global coverage and a maximum gross speed
- Provide 1 access point with an RJ 45 socket for an office used by visitors

■ Legrand services

To guide you in setting up your VDI sites:

- Help with sizing the installation
- On site assistance for integrating products and making important installations secure